

# SEALECTION® 500

9 1/2" MAXIMUM WALL THICKNESS  
 11 1/2" MAXIMUM THICKNESS UNDER FLOOR  
 PER ESR 1172, DATED FEBRUARY 01, 2011

## VENTED CRAWL SPACE

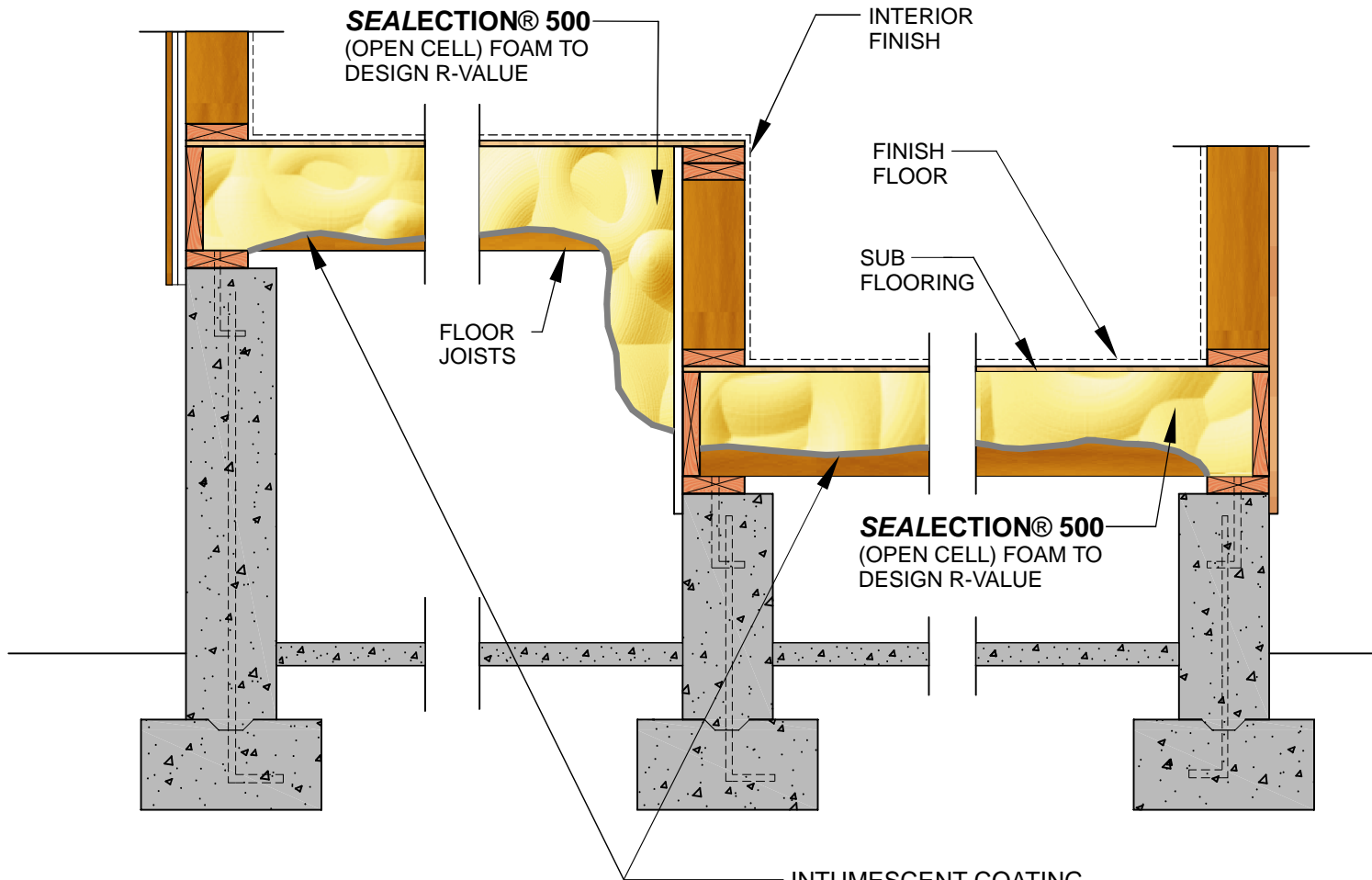

INTUMESCENT COATING  
 ONE OF THE FOLLOWING:  
 5 DRY MILS BLAZEOK IB4  
 6 DRY MILS NO-BURN PLUS XD  
 10 DRY MILS ANDEK FIREGARD



DRAWN BY <b>M.SAUCEDO</b>	<b>DEMILEC USA LLC.</b> SPRAY FOAM INSULATION      ARCHITECTURAL DETAILS VENTED CRAWL SPACE	SCALE <b>N.T.S.</b>
ARCH-65		SHEET NO. <b>1</b>
DATE <b>04-13-2010</b>	2925 GALLERIA DRIVE - ARLINGTON, Tx 76011 - Phone: (817) 640-4900 - Fax: (817) 633-2000 Website: www.DEMILECUSA.com - http://www.sealection500.com - E-mail: Info@DEMILECUSA.com	